

\$3,188,888 - 240206 Vale View Road, Rural Rocky View County

MLS® #A2189899

\$3,188,888

0 Bedroom, 0.00 Bathroom,
Land on 160.00 Acres

NONE, Rural Rocky View County, Alberta

160 (+/-) acre parcel of land designated A-Gen, APPROXIMATELY 20 MINUTES TO CALGARY CITY LIMITS & 10 MINUTES TO CHESTERMERE CITY LIMITS AS WELL AS LANGDON CITY LIMITS! This parcel has a lot of potential with its location and size for future development. Directions: Travel east on Highway 1 (16 Ave) from Calgary, past Chestermere. Turn south on Highway 9, take the first right onto Township Rd 242, and follow west to Vale View Road (no sign on property). Contact your favorite realtor for a viewing today!

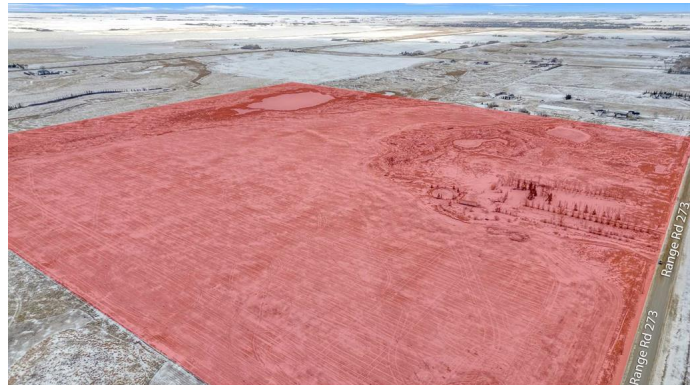

Essential Information

| | |
|-----------|-----------------|
| MLS® # | A2189899 |
| Price | \$3,188,888 |
| Bathrooms | 0.00 |
| Acres | 160.00 |
| Type | Land |
| Sub-Type | Commercial Land |
| Status | Active |

Community Information

| | |
|-------------|-------------------------|
| Address | 240206 Vale View Road |
| Subdivision | NONE |
| City | Rural Rocky View County |
| County | Rocky View County |

| | |
|-------------|---------|
| Province | Alberta |
| Postal Code | T1X 2G2 |

Additional Information

| | |
|----------------|--------------------|
| Date Listed | January 30th, 2025 |
| Days on Market | 63 |
| Zoning | A-GEN |

Listing Details

| | |
|----------------|------------|
| Listing Office | eXp Realty |
|----------------|------------|

Data is supplied by Pillar 9â„¢ MLSÂ® System. Pillar 9â„¢ is the owner of the copyright in its MLSÂ® System. Data is deemed reliable but is not guaranteed accurate by Pillar 9â„¢. The trademarks MLSÂ®, Multiple Listing ServiceÂ® and the associated logos are owned by The Canadian Real Estate Association (CREA) and identify the quality of services provided by real estate professionals who are members of CREA. Used under license.