

# \$399,000 - Nw-01-28-26-w4 / On Hwy 9 And Rge Rd 261, Rural Rocky View County

MLS® #A2195672

**\$399,000**

0 Bedroom, 0.00 Bathroom,  
Land on 31.38 Acres

NONE, Rural Rocky View County, Alberta

Attention Investors and developers... Opportunity is knocking! This 31-acre parcel on Highway 9 in Beiseker with great development opportunity and over 3000 feet of Highway exposure in one of Alberta's main corridors at only 40 minutes to Calgary. Great development opportunity for country residential acreages, industrial, highway commercial, etc. New water well on property. Access is via the road approach on RGE RD 261. Don't miss out and call today details!



## Essential Information

|           |                  |
|-----------|------------------|
| MLS® #    | A2195672         |
| Price     | \$399,000        |
| Bathrooms | 0.00             |
| Acres     | 31.38            |
| Type      | Land             |
| Sub-Type  | Residential Land |
| Status    | Active           |

## Community Information

|             |                           |
|-------------|---------------------------|
| Address     | Nw-01-28-26-w4 / On Hwy 9 |
| Subdivision | NONE                      |
| City        | Rural Rocky View County   |
| County      | Rocky View County         |
| Province    | Alberta                   |
| Postal Code | T0M 0M0                   |

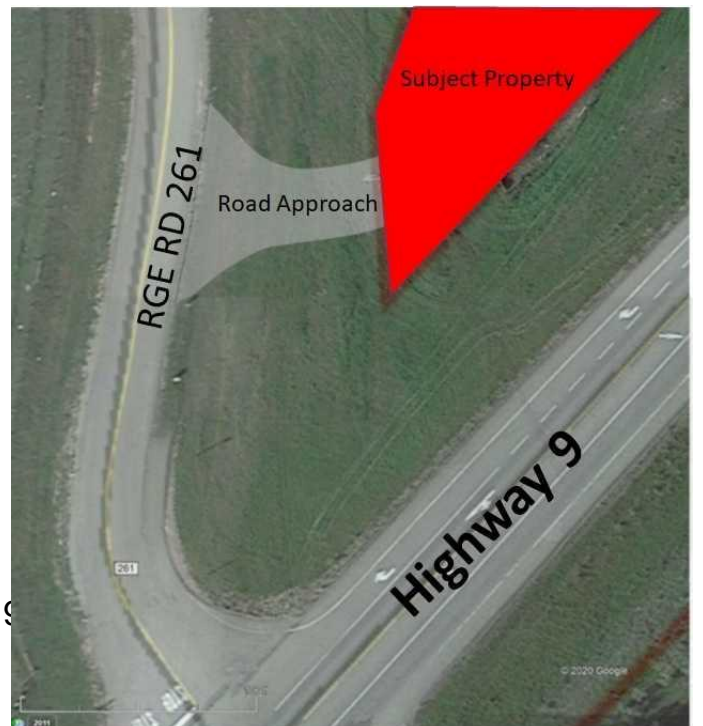

## **Additional Information**

|                |                     |
|----------------|---------------------|
| Date Listed    | February 19th, 2025 |
| Days on Market | 48                  |
| Zoning         | A-SML p8.1          |

## **Listing Details**

|                |            |
|----------------|------------|
| Listing Office | CIR Realty |
|----------------|------------|

Data is supplied by Pillar 9â,,ç MLSÂ® System. Pillar 9â,,ç is the owner of the copyright in its MLSÂ® System. Data is deemed reliable but is not guaranteed accurate by Pillar 9â,,ç. The trademarks MLSÂ®, Multiple Listing ServiceÂ® and the associated logos are owned by The Canadian Real Estate Association (CREA) and identify the quality of services provided by real estate professionals who are members of CREA. Used under license.